

Cylindrical Grinders
EGP series

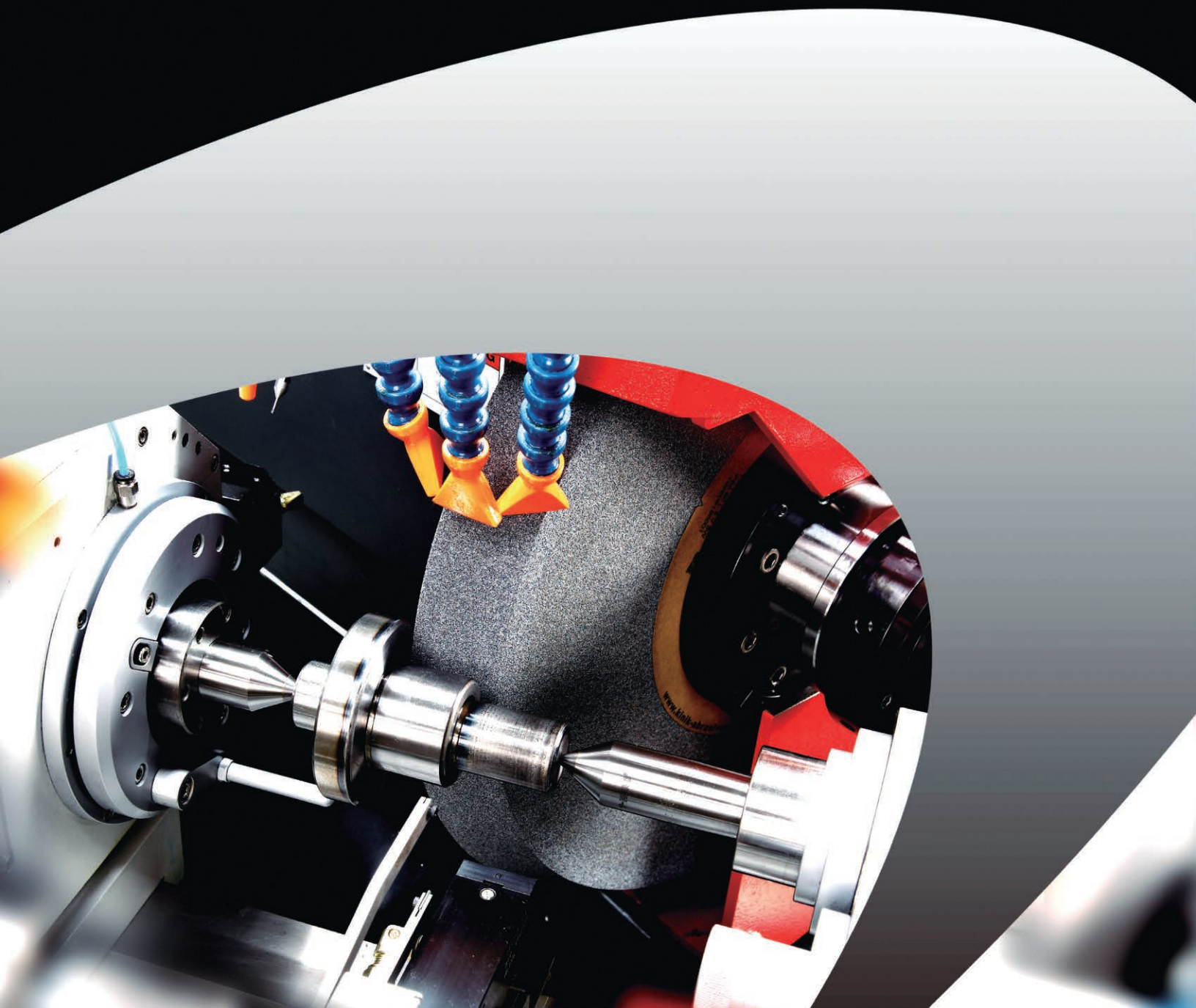

Grinder Professionals
www.etechtw.com



e-tech

Cylindrical Grinder

EGP-20/25/32/38/45

- The EGP series offers a range of 200/250/320/380/450mm swing and a choice of 500/600/1000/1500/2000mm center distance for various grinding solutions.
- Available in manual infeed (M/H models) and automatic infeed (NC models).

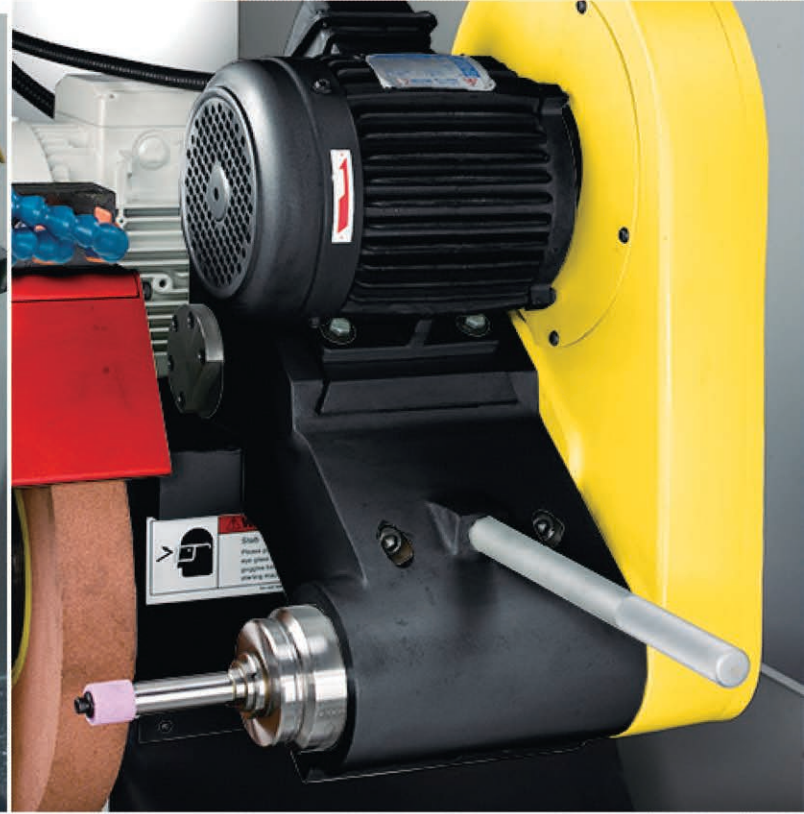
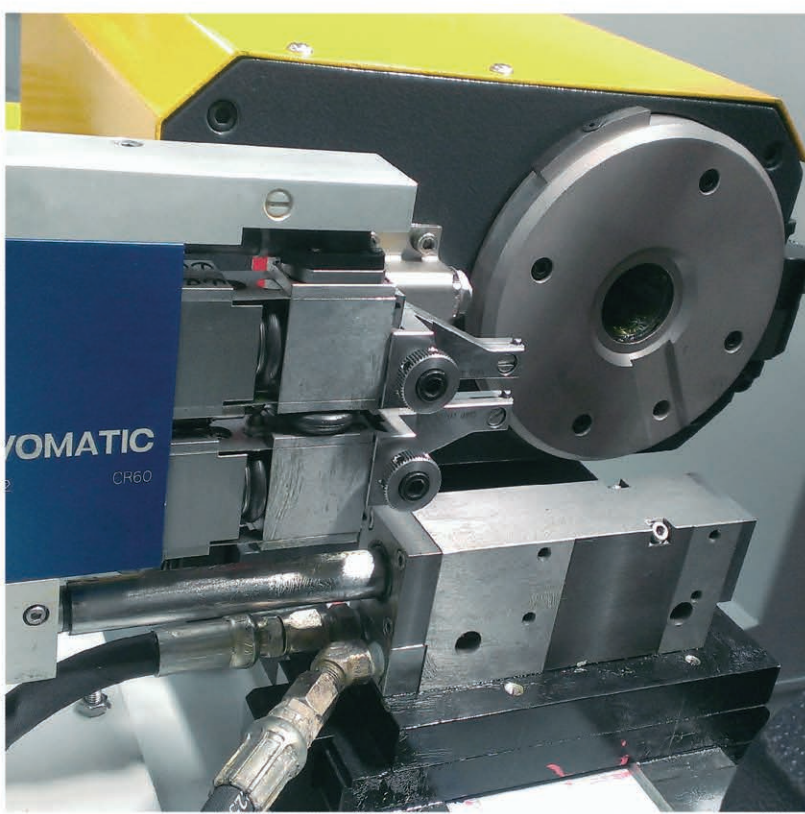



machine concept

e-tech Machinery Inc. introduces EGP series Cylindrical grinders, available in manual infeed (M/H models) and automatic infeed (NC models). The EGP series offers a range of 200/250/320/380/450mm swing and a choice of 500/600/1000/1500/2000mm center distance for various grinding solutions. The application is further extended with the optional swing down internal grinding attachment. All models feature a Meehaite box-type machine bed, hydrostatic guideways for work table, a variable speed work-head, a separate hydraulic system, a 3 HP/EGP-2550(for EGP 20) or 7.5HP/EGP32 and above (4P) (EGP 25) spindle motor with a cartridge type spindle, and an automatic lubrication system for superior grinding precision and productivity. NC models are equipped with user friendly PLC control panel with a menu-driven LCD touch screen. Operators need only to select desired grinding cycle and then input setting data to perform automatic grinding cycle. An optional overhead parallel dresser with automatic compensation system to reduce cycle time and obtain better surface finish.

The heavily ribbed box-type base is made of Meehanite castings, with outstanding rigidity and stability. Optimal distance between guideways span offers excellent table supports to increase Z axis positioning accuracy and durability.

The highly rigid-designed workhead is equipped with precision bearings, with the inverter motor 30-350 variable speeds, enables the workhead swivels 90° counterclockwise to 30° clockwise for various grinding operations. A combination of live and fixed-type spindle design allows for quick change over from center tips to chuck operation. The design of the tailstock is both rigid and robust. Housed in a cast body, the hardened alloy steel sleeve is designed to carry an MT4 center or optional MT5 center. An optional hydraulic tailstock with a foot pedal is available for easy loading and unloading of parts. The spring force of the sleeve can be modified through the adjusting switch.

Wheel head infeed system (The double V guideways) is hand scraped and Turcite coated, utilizing an automatic lubrication system, a precision ball screw, and AC servo motor. This combination allows smooth movement of the wheel head and delivers superior positioning accuracy and repeatability.

MACHINE CONTROL



control and software

PLC Control uses a menu-driven LCD touch screen technology for simple operation.(NC Model). The machine is equipped with a PLC control along with a color touch screen and a user-friendly interface. The operator can simply set up the grinding amount and start a new grinding cycle. The last grinding cycle setting will be saved automatically and can be easily repeated by simply pressing the "Cycle Start" button.

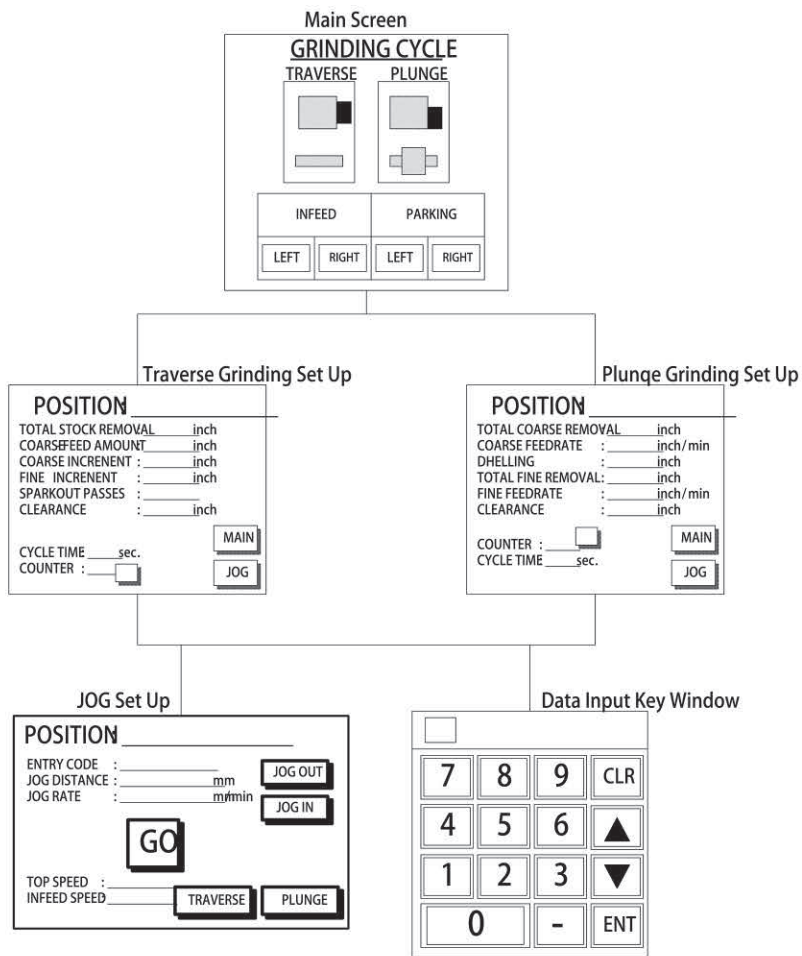

PLC Control Panel

Step 1: Choose the following functions: Grinding mode selection/Infeed selection/Table parking selection/Jog setting/Next screen

Step 2: Input data to set total stock removal, total fine grinding amount, rough increment, fine increment, spark-out passes and reset distance, and then press cycle start to complete the automatic grinding cycle.

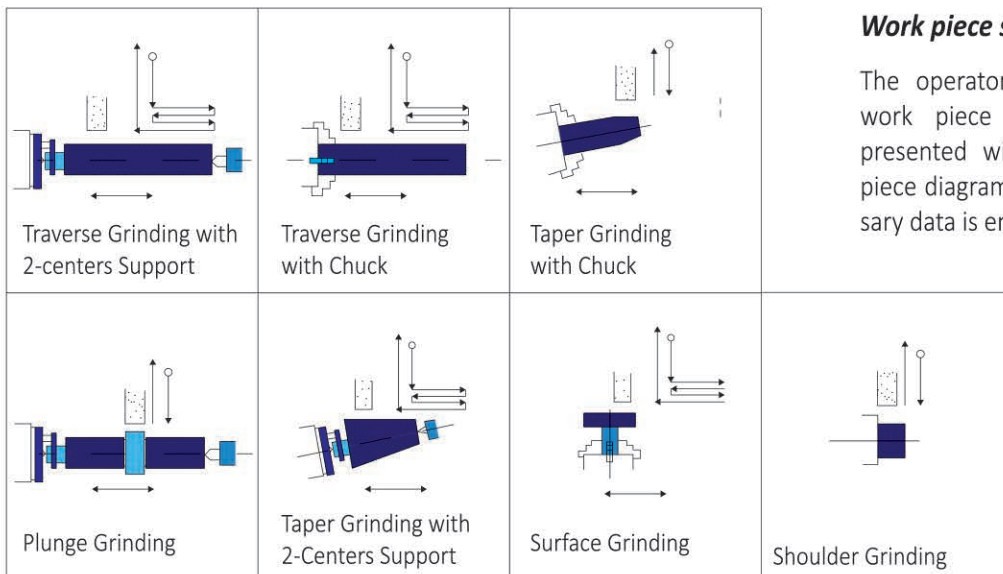

Work piece shape selection

The operator chooses a common work piece shape and is then presented with the relevant work piece diagram into which the necessary data is entered.

SPECIFICATIONS

| Model | | Unit | EGP2050 M/NC | EGP2550 H/NC |
|-------------------|----------------------------------|--------|-------------------|--------------------------------------|
| Item | | | | |
| General Capacity | Distance between centers | mm | 500 | 500 |
| | Swing over table | mm | Ø220 | Ø260 |
| | Max. grinding diameter | mm | Ø200 | Ø250 |
| | Max. load held between centers | kg | 80 | 80 |
| Grinding Wheel | Diameter x Width x Bore | mm | Ø355x38xØ127 | Ø355x38xØ127 |
| | Spindle speed (60HZ/50HZ) | rpm | 1620/1960 | 1800 |
| Wheelhead | Swiveling angle (Left/Right) | | Fixed | ±30° |
| | Infeed travel | mm | 160 | 135 |
| | Manual infeed | mm | 160 | 90 |
| | Top slide travel | mm | - | 180 |
| | Auto increment infeed (NC model) | mm | - | Ø0.001-Ø0.999 |
| | Handwheel pre graduation | mm | Ø0.005 | Ø0.004(0.001/0.01/0.1MPG) |
| | Handwheel pre revolution | mm | Ø2(0.01/0.1/1MPG) | Ø2(0.01/0.1/1 MPG) |
| Workhead | Swiveling angle (Left/Right) | degree | ±45° | ±45° |
| | Center taper | | MT3 (opt. 5C) | MT3 (opt. 5C) |
| | Spindle speed | rpm | 150/264/356/480 | 150/264/356/480 |
| Tailstock | Center taper | | MT3 | MT3 |
| | Quill travel | mm | 25 | 25 |
| Table | Swiveling angle (Left/Right) | degree | ±8° | ±8° |
| | Traverse speed | mm/min | 80/140/230 | 30-7000 |
| | Handwheel per revolution | mm | 9 | 10 |
| Internal grinding | Spindle speed | rpm | 14000/25000 | 12000/18000/25000 (40000/50000 opt.) |
| | Max. grinding bore | mm | Ø24-70 | Ø30-100/Ø20-50 |
| | Max. grinding length | mm | 70 | 110/55 |
| | Max. chucking length | mm | 275 | 315 |
| | Max. chucking diameter | mm | Ø110 | Ø150 |
| Motors | Wheel spindle motor | HP | 3 (4P) | 5 (4P) |
| | Workhead spindle motor | HP | 1/2(4P) | 1/2(4P) |
| | Coolant pump | HP | 1/8(4P) | 1/8(4P) |
| | Hydraulic pump | HP | - | 2(4P) |
| | Internal grinding motor | HP | 1/2(2P) | 2(4P) |
| Machine | Net weight | kg | 1850 | 2800 |
| | Gross weight | kg | 2250 | 3200 |
| | Packing dimension (LxWxH) | mm | 2270x2270x1880 | 2280x2280x1940 |

| Model | | Unit | EGP32/EGP38/EGP45-60/100/150/200 H/NC | | | |
|-------------------|----------------------------------|--------|---------------------------------------|------|------|------|
| Item | | | | | | |
| General Capacity | Distance between centers | mm | 600 | 1000 | 1500 | 2000 |
| | Swing over table | mm | Ø320/Ø380/Ø450 | | | |
| | Max. grinding diameter | mm | Ø300/Ø360/Ø430 | | | |
| | Max. load held between centers | kg | 150 | | | |
| Grinding Wheel | Diameter x Width x Bore | mm | Ø405x50xØ127 | | | |
| | Spindle speed (60HZ/50HZ) | rpm | 1650 | | | |
| Wheelhead | Swiveling angle (R&L) | degree | ±30° | | | |
| | Infeed travel | mm | 245 | | | |
| | Manual infeed | mm | 200 | | | |
| | Top slide travel | mm | 180 | | | |
| | Auto increment infeed (NC model) | mm | 45(H MODEL)/Ø0.001~Ø0.999(NC MODEL) | | | |
| | Handwheel pre graduation | mm | Ø0.004(0.001/0.01/0.1MPG) | | | |
| | Handwheel pre revolution | mm | Ø2(0.01/0.1/1MPG) | | | |
| Workhead | Swiveling angle (R&L) | degree | ±90° | | | |
| | Center taper | | MT4 (opt. MT5, 5C) | | | |
| | Spindle speed | rpm | 30-350 (infinite variable speeds) | | | |
| Tailstock | Center taper | | MT4 (opt. MT5) | | | |
| | Quill travel | mm | 25 | | | |
| Table | Swiveling angle (R&L) | degree | ±9° | ±7° | ±5° | ±3° |
| | Traverse speed | mm/min | 30-7000 | | | |
| | Handwheel per revolution | mm | 10 | | | |
| Internal grinding | Spindle speed | rpm | 12000/18000/25000 (40000/50000opt.) | | | |
| | Max. grinding bore | mm | Ø30-100/ Ø20-50 | | | |
| | Max. grinding length | mm | 110/55 | | | |
| | Max. chucking length | mm | 315 | | | |
| | Max. chucking diameter | mm | Ø150 | | | |
| Motors | Wheel spindle motor | HP | 7.5(4P)/ (10opt.) | | | |
| | Workhead spindle motor | HP | 2(4P) | | | |
| | Coolant pump | HP | 1/4(2P) | | | |
| | Hydraulic pump | HP | 2(4P) | | | |
| | Internal grinding motor | HP | 2(4P) | | | |
| Machine | Net weight | kg | 3500 | 3600 | 4700 | 6000 |
| | Gross weight | kg | 4000 | 4700 | 5600 | 6780 |
| | Packing dimension (LxWxH) | mm | 3030X2250X2033 | | | |

All specifications and features are subject to change without further notice.



Available on the
App Store



ANDROID APP ON
Google play

e-techMachinery, Inc.

No.36, Ln.686, Sec.4, Changping Rd.,
Daya Dist., Taichung City 428
Taiwan(R.O.C)
info@etechtw.com

e-techUSA

6435 Alondra Blvd, Paramount,
CA.90723
info@etechtw.com

e-techChina

No.1288 Chengbei Middle Road, Yushan
Town, Kunshan City, Jiangsu.
(China Zhengtailong International
Equipment Purchase Center, Hall 8,
1F-A13, 2F-D17)
info@etechtw.com